

PACIFIC PLACE BUILDING



Highlights

Prime location in the center of the capital.

Competitive rental rates.

Integrating many utilities, luxurious style.

Factsheets

Landlord: **Mapletree Group**

Parking: **5 basements**

Floors: **19 floors + 5 basements**

Elevators: **4 high speed elevator**

Ceiling height: **2,7 meter**

Air-conditioning: **Central air - conditioning system**

Net Leasing/floor: **1.033 sqm**

Backup power: **100% productivity**

Building orientation: **Northeast**

Working hours: **From Monday to Friday: 8h -18h; Saturday: 8h - 12h30**

Building completion: **2007**

Grade: **Grade A**

Last updated on: 26/10/2023

The data is for reference only at the time of update.

Rent Condition

Asking Rent: **37.3\$/sqm/month**

Service Charge: **Included in the rental price**

Service charge includes: **Camera system for surveillance, security and protection., General sanitary treatment system, public service.**

Payment: **Quarterly**

Handover condition: **Elevator, air conditioner, generator, wall glass, flat rolled concrete floor, walls and partitions of rented area, drop ceiling, lighting**

Motorbike Parking Fee: **155.000d/space/month**

Out of working hour fee: **0.22\$/sqm/hour**

Minimum Contract Period: **3 years**

Electricity fee: **According to the state price**

Handover time: **Immediately**

Car Parking Fee: **3.300.000d/space/month**

Available spaces

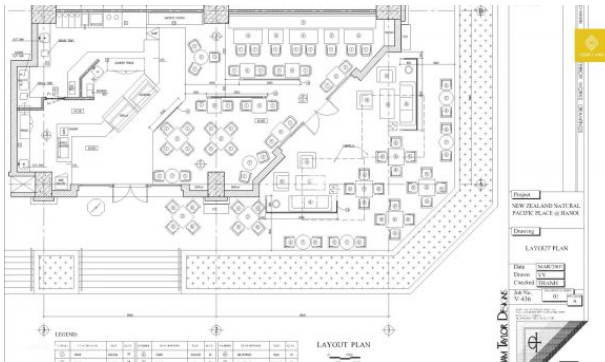

Pacific Place Building

Facilities

Integrating many banks, shopping stores, services, dining: HSBC, Highland Coffee.

Swimming pool for VIP guests.

View on map



Hà Nội

Address: Tầng 3B, Tòa nhà Sông Đà, Phạm Hùng, Nam Từ Liêm

Phone: [024.66609700](tel:024.66609700)-
[0937967700](tel:0937967700)

Email: info@odinland.vn

Đà Nẵng

Address: Tầng 5, 167 Phan Châu Trinh, Đà Nẵng

Phone: [02363555919](tel:02363555919) -
[0933.248.000](tel:0933.248.000)

Email: mt.dna@odinland.com

Hồ Chí Minh

Address: Tầng 6, Tòa nhà HBT, 458 Hai Bà Trưng, Quận 1

Phone: [02822677700](tel:02822677700) -
[0933248000](tel:0933248000)

Email: hcm@odinland.vn